

Stellar Patrol of the Third Galactic Union

OFFICIAL BLUEPRINTS



The blueprints herein are printed and disbursed solely for the uses and purposes of the Stellar Patrol of the Third Galactic Union as outlined in the Stellar Patrol Blueprint Rules and Regulations Handbook or as determined by an authorized disburser of these blueprints or by any commanding officer provided that such uses or purposes are in a manner consistent with the rules and regulations of the Stellar Patrol. Failure to comply with said rules and regulations with regard to the confidentiality of Stellar Patrol blueprints will be treated as an act of treason and punishment determined accordingly. All local restrictions apply.



Elevator



Bed, standard Patrol issue



Toilet stall



Utility shaft and air duct



Desk and Chair, personal



Access hatch



(Non-closing) Doorway



Chair, reading



Auto-door



Shrubs



Security auto-door

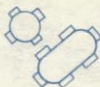

Table and Chairs



Air vent, horizontal



Tub, bathing

FPU

Food Preparation Unit



Shower stall

FDU

Food Dispensing Unit



Toilet



Wardrobe, personal



Sink, SanFac-type

NOTE: Compass directions are relative to standard Galactic North. "UP" and "DOWN" are relative to the Station's internal artificial gravity.

DEEP SPACE STATION
GAMMA-DELTA-GAMMA CLASS

Stellar Patrol Corps
of Engineers

Drawn by:
Cmdr. Trip Flagstone

Scale —

Date: 11337.13.20

KEY

NOTE (I): Only connecting tubes to official Stellar Patrol Deep Space Station Sub-Modules may be attached to Command Module at these points.

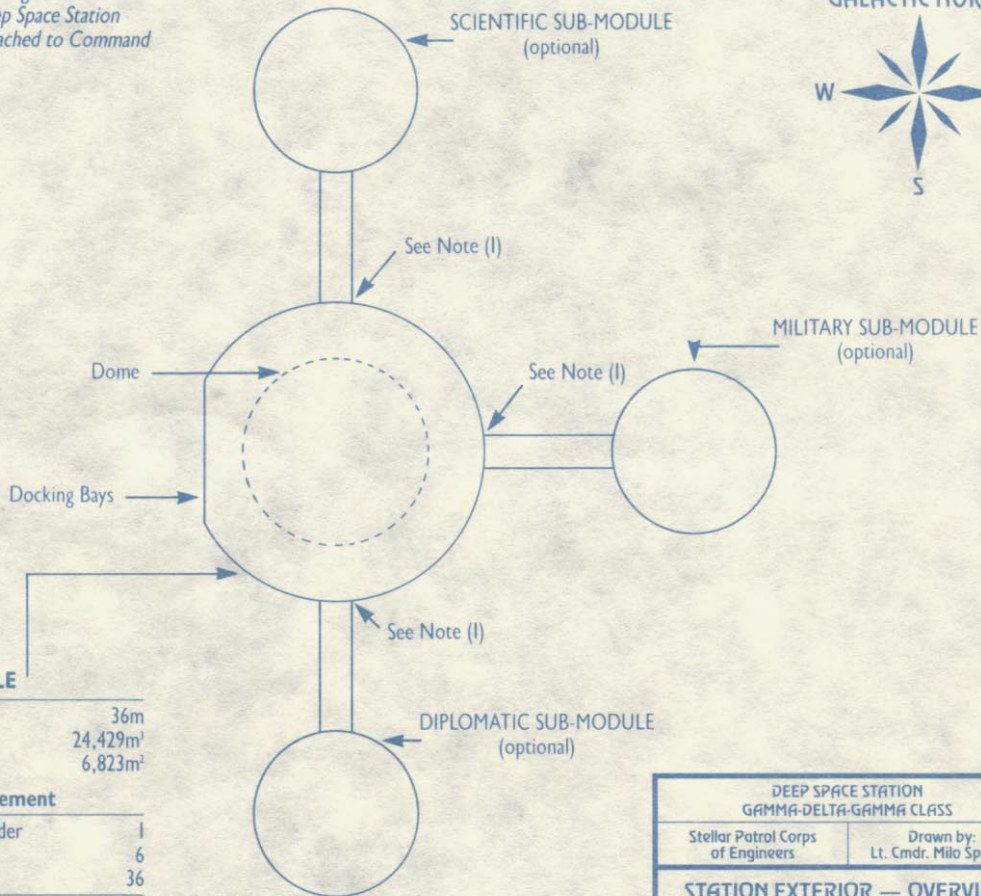

COMMAND MODULE

Diameter	36m
Volume	24,429m ³
Usable floor area	6,823m ²

Normal complement

Station Commander	1
Officers	6
Crew	36
Total Personnel	43

DEEP SPACE STATION GAMMA-DELTA-GAMMA CLASS

Stellar Patrol Corps
of Engineers

Drawn by:
Lt. Cmdr. Milo Spatter

STATION EXTERIOR — OVERVIEW

Scale 1:750

Date: 113375.1

1 OF 9

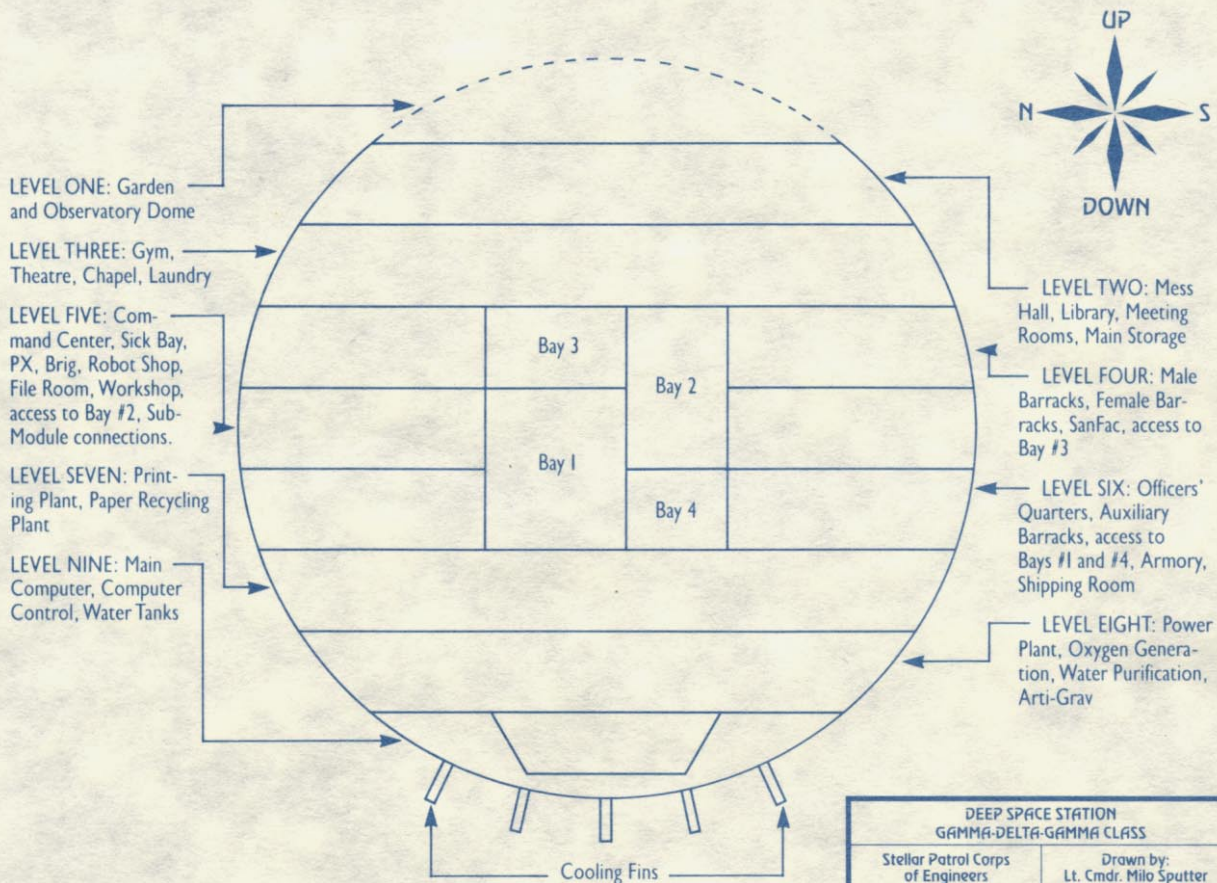

DEEP SPACE STATION GAMMA-DELTA-GAMMA CLASS		
Stellar Patrol Corps of Engineers		Drawn by: Lt. Cmdr. Milo Sputter
COMMAND MODULE INTERIOR—SIDE VIEW CUTAWAY		
Scale 1:375	Date: 113375.2	2 OF 9

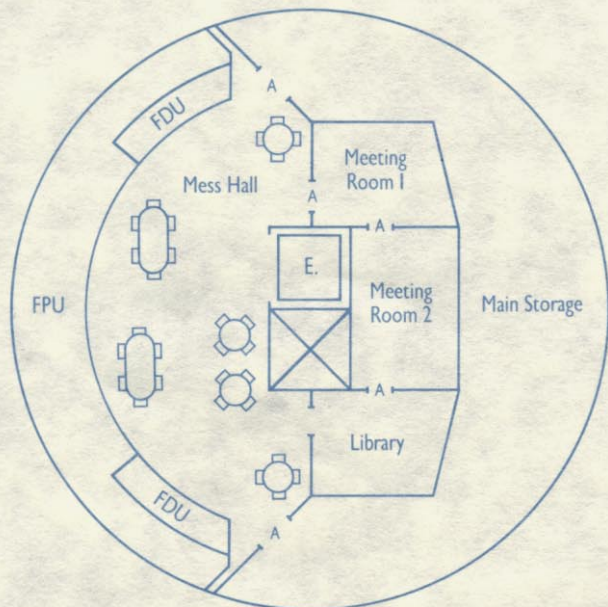

LEVEL TWO

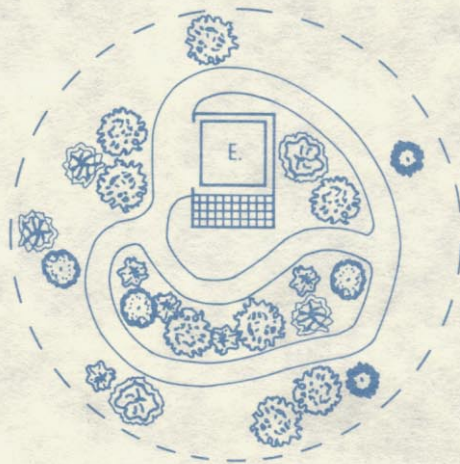

LEVEL ONE

DEEP SPACE STATION GAMMA-DELTA-GAMMA CLASS		
Stellar Patrol Corps of Engineers		Drawn by: Lt. Cmdr. Milo Sputter
COMMAND MODULE—LEVEL ONE & LEVEL TWO PLAN		
Scale 1:375	Date: 113375.5	3 OF 9

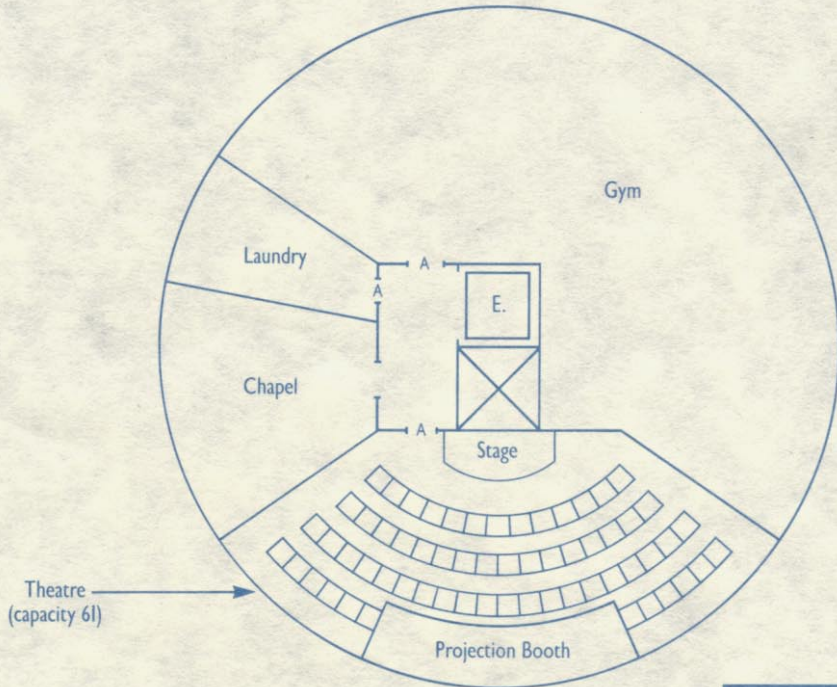

Theatre
(capacity 61)

DEEP SPACE STATION GAMMA-DELTA-GAMMA CLASS		
Stellar Patrol Corps of Engineers	Drawn by: Lt. Cmdr. Milo Sputter	
COMMAND MODULE LEVEL THREE PLAN		
Scale 1:375	Date: 113375.12	4 OF 9

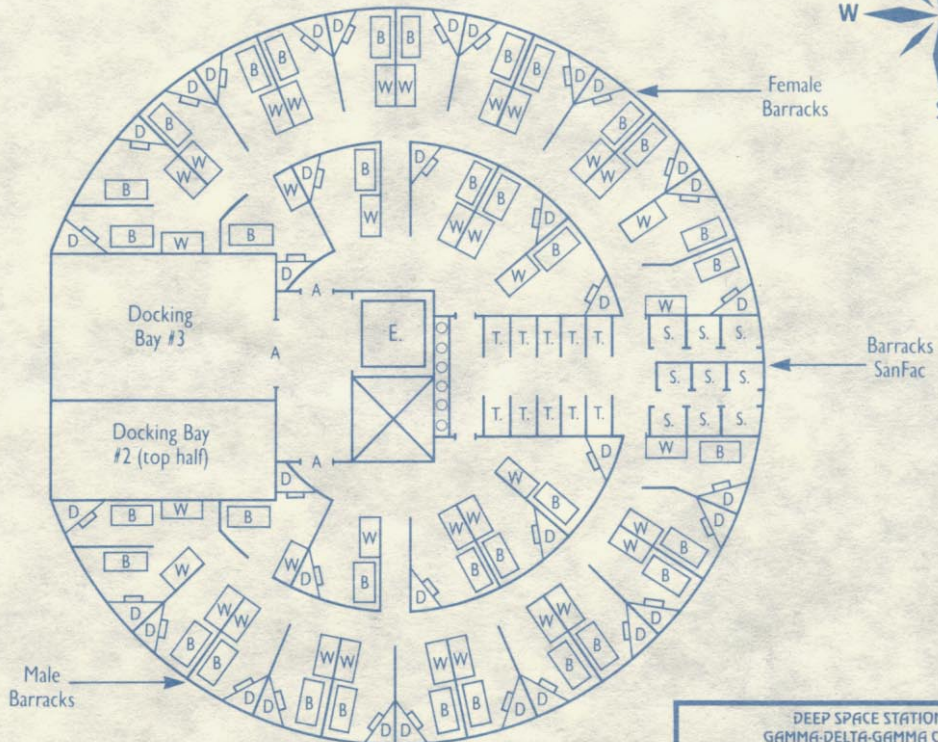

DEEP SPACE STATION GAMMA-DELTA-GAMMA CLASS		
Stellar Patrol Corps of Engineers	Drawn by: Lt. Cmdr. Milo Sputter	
COMMAND MODULE LEVEL FOUR PLAN		
Scale 1:375	Date: 11337.6.8	5 OF 9

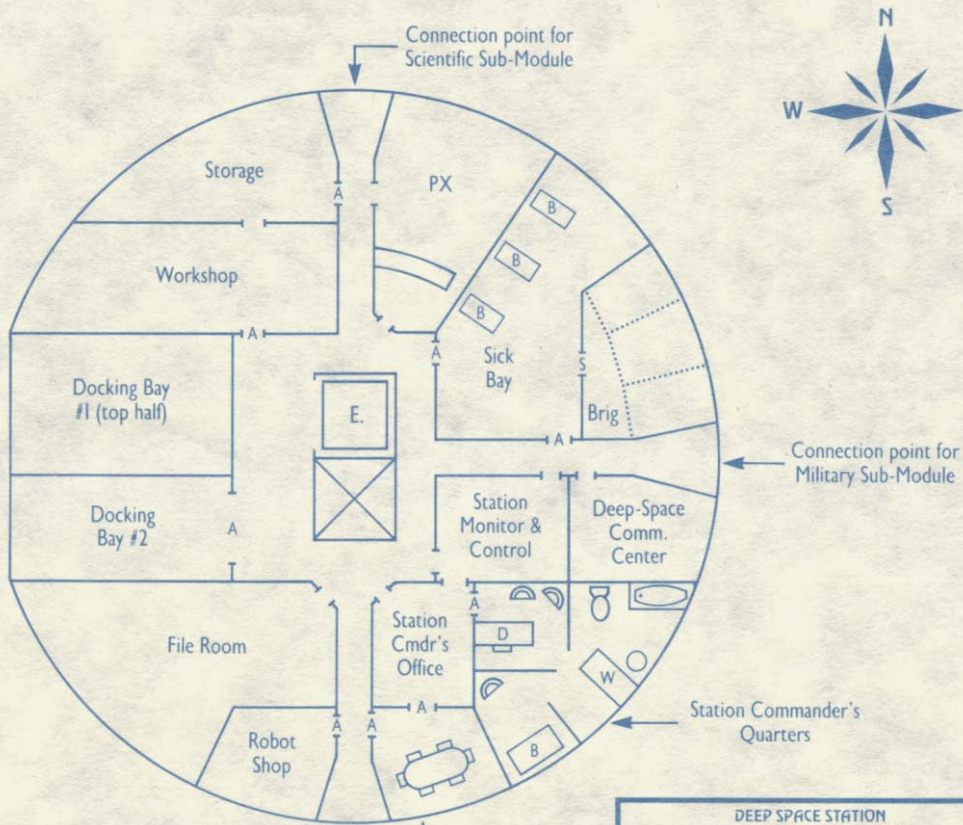

Connection point for Diplomatic Sub-Module

Station Commander's Briefing Room

Station Commander's Quarters

Connection point for Military Sub-Module

Connection point for Scientific Sub-Module

DEEP SPACE STATION GAMMA-DELTA-GAMMA CLASS		
Stellar Patrol Corps of Engineers	Drawn by: Lt. Cmdr. Milo Sputter	
COMMAND MODULE LEVEL FIVE PLAN		
Scale 1:375	Date: 113378.18	6 OF 9

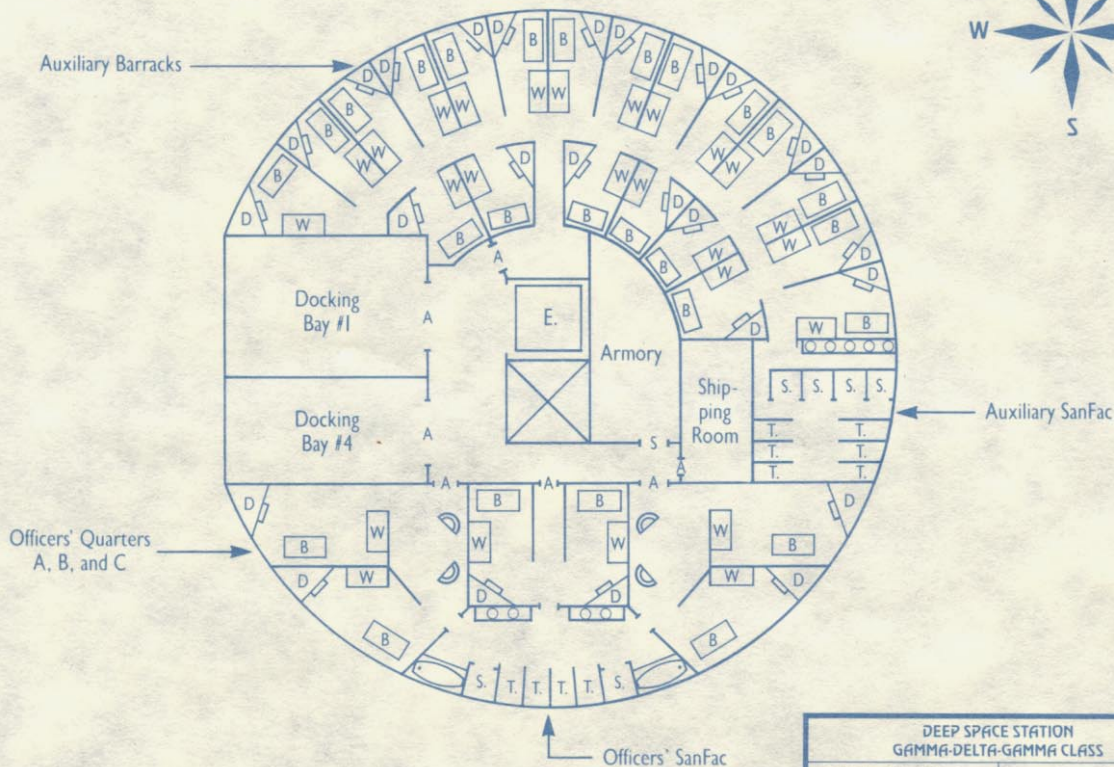

DEEP SPACE STATION
GAMMA-DELTA-GAMMA CLASS

Stellar Patrol Corps
of Engineers

Drawn by:
Lt. Cmdr. Milo Sputter

COMMAND MODULE LEVEL SIX PLAN

G-IS6-8BLUE

Scale 1:375

Date: 1133713.10

7 OF 9

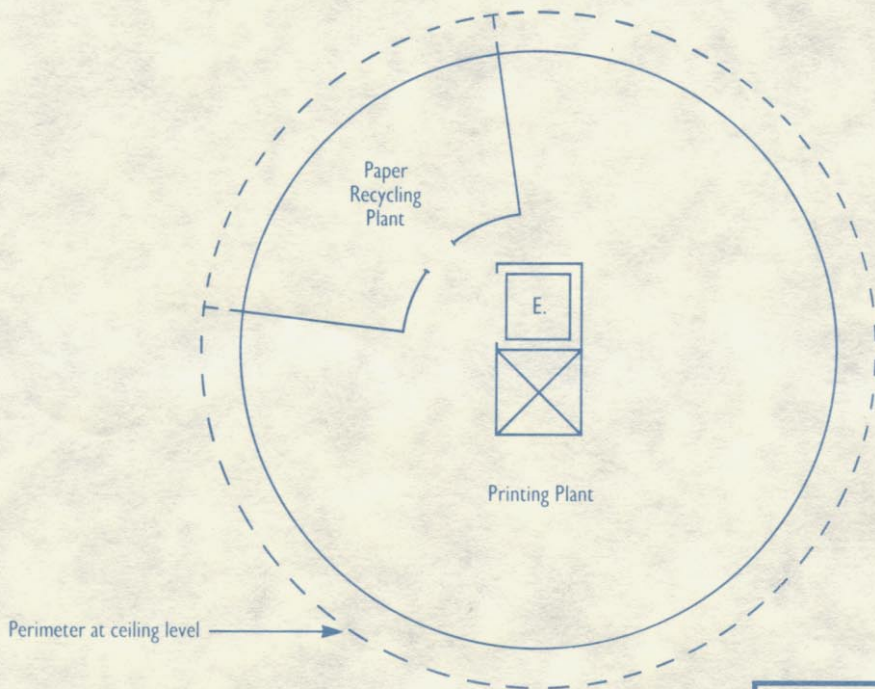

Perimeter at ceiling level

DEEP SPACE STATION
GAMMA-DELTA-GAMMA CLASS

Stellar Patrol Corps
of Engineers

Drawn by:
Cmdr. Trip Flagstone

COMMAND MODULE LEVEL SEVEN PLAN

G-IS6-9BLUE

Scale 1:375

Date: 11337.13.20

8 OF 9

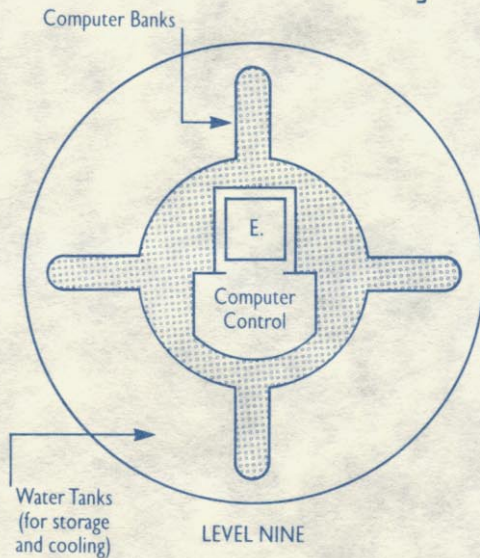
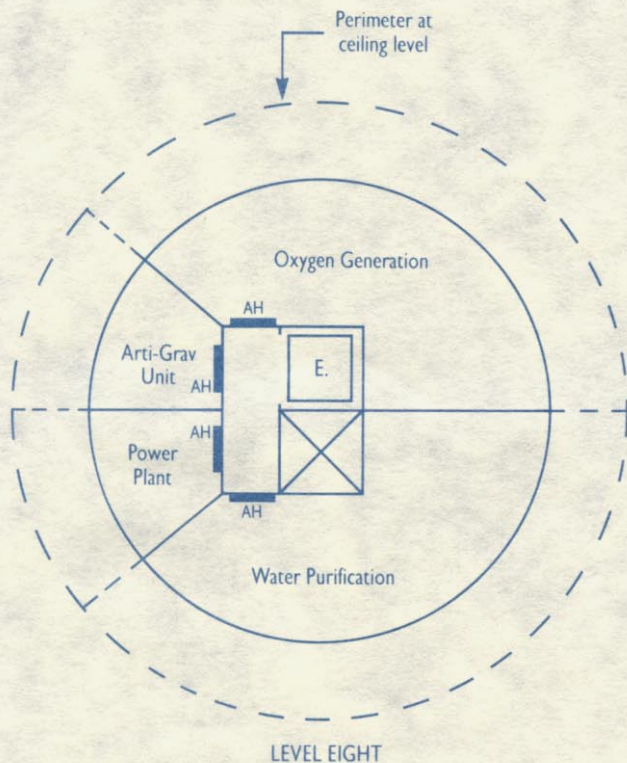

DEEP SPACE STATION GAMMA-DELTA-GAMMA CLASS		
Stellar Patrol Corps of Engineers	Drawn by: Cmdr. Trip Flagstone	
COMMAND MODULE LEVEL EIGHT & NINE PLAN		
Scale 1:375	Date: 11337.13.20	9 OF 9

